



## International Scientific Instruments

(Importers and Distributors of Electronic Equipment)  
140 Darling Road, East Malvern, Vic. 3145, Australia  
PO Box 1215  
Darling, Vic. 3145, Australia  
Telephone: (03) 9571 7719 International: 61 3 9571 7719  
Fax: (03) 9571 9977 International: 61 3 9571 9977  
E-mail: [sales@interscientific.com.au](mailto:sales@interscientific.com.au)  
Web: [www.interscientific.com.au](http://www.interscientific.com.au)

### VIBRATION CONDITION MONITORING SYSTEM GLUE ON 1/4-28 UNF ACCELEROMETER MOUNTING STUD

PART NO.: M/1428 GLU  
MATERIAL: Grade 303 Stainless Steel

REV 'B'

**\$25 plus GST**

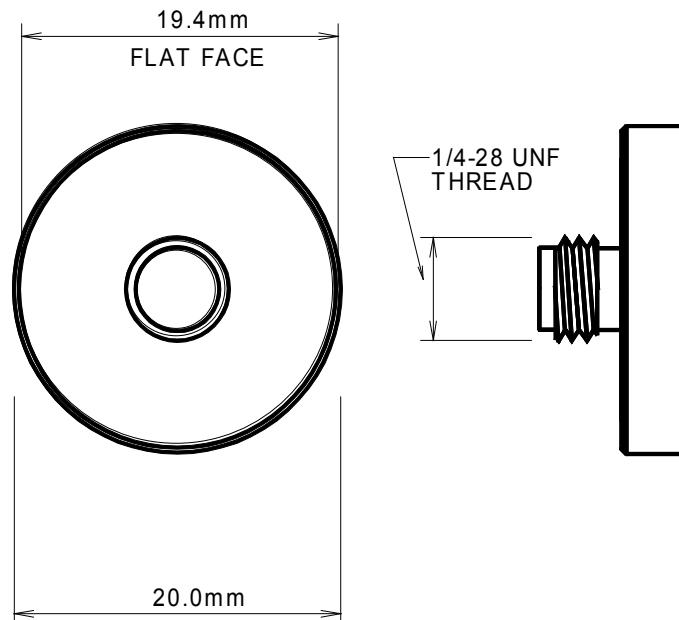

#### **INSTALLATION**

1. Remove paint and or protective coatings to expose the bare surface. Thoroughly clean and degrease the surface which the stud will be attached. (NB. The stud location should allow sufficient clearance for use of either a 26 or a 42 mm diameter accelerometer.)
2. Attach the stud to the surface, using adhesive suitable for the application. (Consult manufacturer specifications).

**NB** The use of 5 minute type epoxy or superglue become soft as temperature rises rendering the stud useless for hot machinery applications.